

AERIAL LADDER FIRE TRUCK

MLMA5-32

Specifications

Chassis	SCANIA P410
Overall Height	3,300 mm
Overall Length	10,350 mm
Gross Vehicle Weight	17,700 kg
Working Height	31.3 m
Cage Capacity	540 kg (5 persons)
Jacking Width	4.82 m
Outreach	24.7 m
Articulation Angle	90°

*Specifications, descriptions and illustrative material in this literature are as accurate as known at the time of publication, but are subject to change without notice.

Safeguarding Lives
and the Environment



MITA BELLJU BLDG. 19F, 5-36-7 SHIBA,
MINATO-KU, TOKYO, 108-0014, JAPAN
PHONE +81-3-6400-3484 FAX +81-3-6400-4553



26.05-01 SP



**DELIVERING JAPAN QUALITY,
BUILT ON TRUST, TO THE WORLD**

A WORLD-CLASS LADDER TRUCK EXCELLING IN SAFETY,
MOBILITY, AND OPERATIONAL EXCELLENCE

Built on 119 years of engineering expertise and a durable design refined for Japan's diverse environments. Repeated durability testing and proprietary R&D ensure stable performance. Compliant with Japanese safety standards as well as EN14043 standards.



SAFETY



Gyro-turnstile System

The gyro-turnstile system automatically levels the ladder turntable, enabling safe operation even on sloped terrain of up to 11°.



Rescue Cage

With a high load capacity of 540kg and a spacious platform area, it supports a wide range of rescue operations. Dual front access doors provide smooth entry and transfer.

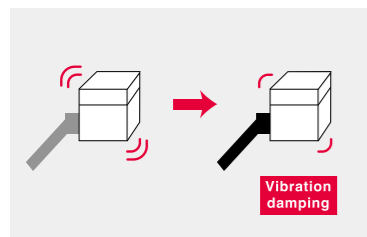

Vibration Reduction System

Vibrations during ladder elevation and rotation are detected and actuator output is adjusted to suppress ladder vibration, ensuring safe operation.

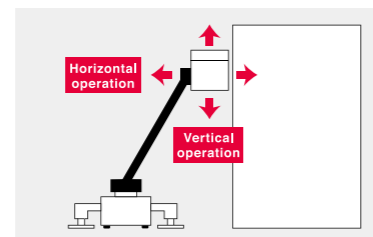

Vertical and Horizontal Operation Mode

Enables vertical and horizontal rescue cage movement with a single lever. It allows intuitive operation without complex controls, improving safety and reducing operation time.

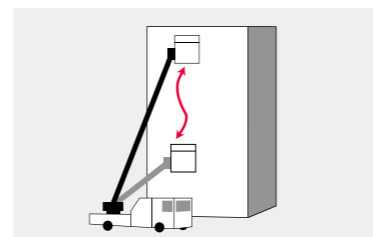

Memory Control System

By recording ladder operations, movements can be replayed and reversed, reducing operator workload. The 3D display of ladder status enables intuitive situational awareness and supports safe operation.

MOBILITY



Jacks and Outriggers

With a maximum outrigger extension width of 4.82 m,

It supports operations in narrow spaces. The single-side outrigger mode enables operation in even more limited areas.



Top Articulation Section

With a 90° articulation angle and a 4m articulated section,

It enables access over obstacles, expanding the operational range.



Water Monitor

Supports high flow water discharge up to 2,500 L/min.

The monitor is permanently mounted on the rescue cage, enabling rapid deployment without on-site installation or removal. Center positioning distributes reaction forces, ensuring safe operation during firefighting activities.



Front Rescue Cage Entry

By lowering the rescue cage in front of the cab, direct access is enabled, allowing operation even in areas with limited side space on either side of the vehicle.

OPERABILITY



Base / Cage Control Station

A universal-design color display provides clear and simple information, enabling intuitive operation for fast and reliable response. The operator seat features a tilt mechanism to reduce operator fatigue and a protective roof to ensure safety. The compact cage control station ensures sufficient working space for operations.

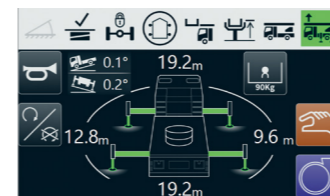

Rear Control Station

A color display, consistent with the ladder operation system, clearly shows not only jack and outrigger status but also outreach and other operational conditions.



Improved Visibility

LED lights integrated into the articulated section improve visibility at night. Together with rescue cage and ladder lighting, they support safe operation.